

vtech[®]

User's Manual

Rock & Sing Musical Car™



© 2005 VTech
Printed in China
91-02139-000 (美)

Dear Parent:

Ever notice the look on your baby's face when they learn something new through their own discovery? These self-accomplished moments are a parent's greatest reward. To help fulfill them, **VTech®** created the **Infant Learning**, series of toys.

These unique interactive learning toys directly respond to what children do naturally – play! Using innovative technology, these toys react to baby's interactions, making each play experience fun and unique as they learn age-appropriate concepts like first words, numbers, shapes, colors and music. More importantly, **VTech®**'s **Infant Learning** toys develop baby's mental and physical abilities by inspiring, engaging and teaching.

At **VTech®**, we know that a child has the ability to do great things. That's why all of our electronic learning products are uniquely designed to develop a child's mind and allow them to learn to the best of their ability. We thank you for trusting **VTech®** with the important job of helping your child learn and grow!

Sincerely,

Your Friends at **VTech®**

To learn more about **Infant Learning**, and other **VTech®** toys, visit www.vtech.com

INTRODUCTION

Thank you for purchasing the **VTech® Rock & Sing Musical Car™** learning toy!

The **VTech® Rock & Sing Musical Car™** is a musical push toy for toddlers 9 months and up. This musical car is loaded up with music and learning! The three animal characters teach lessons in pitch, tone and tempo with music to reinforce the concept. The light-up percussion buttons introduce sounds and rhythms. The characters will move up and down and side to side reinforcing cause and effect relationships. A variety of fun melodies and a fun upbeat song for added musical enjoyment.

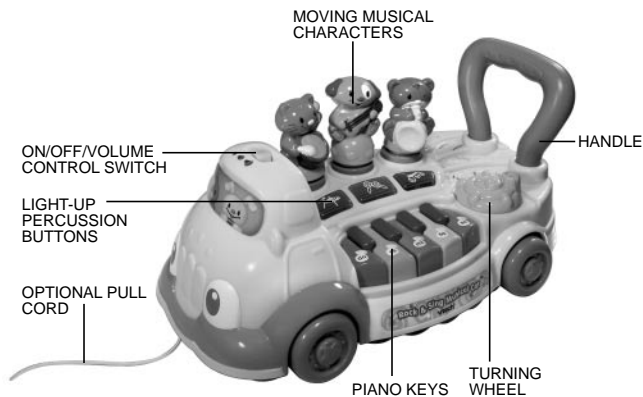

INCLUDED IN THIS PACKAGE

- One VTech® Rock & Sing Musical Car™ learning toy
- One instruction manual

WARNING: All packing materials, such as tape, plastic sheets, wire ties and tags are not part of this toy, and should be discarded for your child's safety.

GETTING STARTED

BATTERY INSTALLATION

1. Make sure the unit is turned **OFF**.
2. Locate the battery cover on the bottom of the unit. Use a screwdriver to loosen the screw.
3. Install 2 new "AA"(UM3/LR6) batteries following the diagram inside the battery box. (The use of new alkaline batteries is recommended for maximum performance.)
4. Replace the battery cover and tighten the screw to secure the battery cover.

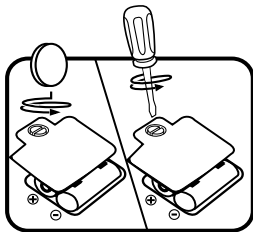

BATTERY NOTICE

- Install batteries correctly observing the polarity (+, -) signs to avoid leakage.
- Do not mix old and new batteries.
- Do not use batteries of different types.
- Remove batteries from the equipment when the unit will not be used for an extended period of time.
- Do not dispose of batteries in fire.
- Do not attempt to recharge ordinary batteries.
- The supply terminals are not to be short-circuited.
- Only batteries of the same and equivalent type as recommended are to be used.
- Do not mix alkaline, standard (carbon-zinc) or rechargeable (nickel-cadmium) batteries.

WE DO NOT RECOMMEND THE USE OF RECHARGEABLE BATTERIES.

PRODUCT FEATURES

1. ON/OFF/VOLUME CONTROL SWITCH

To turn the unit **ON**, slide the **ON/OFF/VOLUME CONTROL SWITCH** to the **LOW VOLUME** (🔊) or **HIGH VOLUME** (🔊🔊) position. To turn the unit **OFF**, slide the **ON/OFF/VOLUME CONTROL SWITCH** to the **OFF** (●) position.

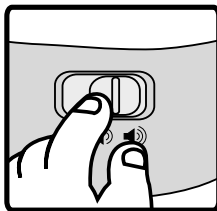

2. AUTOMATIC SHUT-OFF

To preserve battery life, the VTech® Rock & Sing Musical Car™ will automatically power-down after approximately 30 seconds without input. The unit can be turned on again by pressing any button or rolling the unit.

3. PULL CORD

To convert the unit from a push toy to a pull toy, remove the pull cord from the compartment and thread it through the eyelet on the bottom of the car. For your child's safety, we suggest you store the pull cord in the compartment until your child is walking.

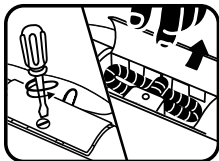

ACTIVITIES

1. Slide the **on/off/volume control switch** to turn the unit on. You will hear a giggle, a phrase and a song. The lights will flash with the sound.

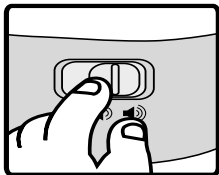

2. Press the **animal characters** to hear musical phrases, short tunes and melodies. The lights will flash with the sound.

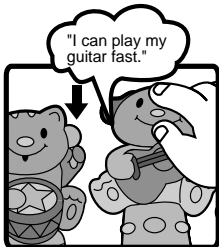

3. Press the **light-up percussion buttons** to hear musical phrases and short rhythms. Press the light-up percussion keys while a melody is playing to change the instrument sound of the harmony. The lights will flash with the sound.



4. Press the **piano keys** to hear individual piano notes. When the piano keys are pressed while a melody is playing, the melody will play one note at a time. The melody will resume normal play when the piano keys are no longer being pressed. The animal characters will move up and down when the piano keys are pressed. The lights will flash with the sound.

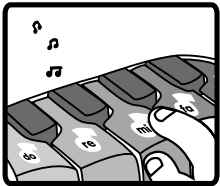

5. Turn the **turning wheel** to hear a fun phrase and a variety of melodies. Turn the wheel while a melody is playing to increase the tempo of the melody. The melody will resume normal play when the wheel is no longer being turned. The animal characters will move side to side when the turning wheel is turned. The lights will flash with the sound.



6. Push the car to hear a song, phrase or a variety of melodies. The lights will flash with the sound.

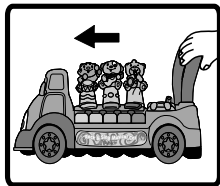

MELODY LIST

1. Flight of the Bumble Bee
2. Brahms' Lullaby
3. Rockin' Robin
4. Skip to My Lou
5. Yellow Rose of Texas
6. Sailor's Hornpipe
7. Yankee Doodle
8. Polly Wolly Doodle
9. Sur le Pont d'Avignon
10. Rondo Alla Turca

SUNG SONG LYRICS(to the tune of Rockin' Robin)

All the little buddies jammin' in the band,
Twistin' and turnin' and clapping their hands.
Keep on rockin'!
Keep on boppin'!
Jam it, spin it, rock it, join us and sing along!

CARE & MAINTENANCE

1. Keep the unit clean by wiping it with a slightly damp cloth.
2. Keep the unit out of direct sunlight and heat source.
3. Remove the batteries when the unit is not in use for an extended period of time.
4. Do not drop the unit on hard surfaces and do not expose the unit to moisture or water.

TROUBLESHOOTING

If for some reason the program/activity stops working or malfunctions, please follow these steps:

1. Turn the unit **OFF**.
2. Interrupt the power supply by removing the batteries.
3. Let the unit stand for a few minutes, then replace the batteries.
4. Turn the unit **ON**. The unit should now be ready to play again.
5. If the product still does not work, replace with a new set of batteries.

If the problem persists, please call our Consumer Services Department at 1-800-521-2010 in the U.S. or 1-877-352-8697 in Canada, and a service representative will be happy to help you.

For information on this product warranty, please call **VTech**® at 1-800-521-2010 in the U.S. or 1-877-352-8697 in Canada.

IMPORTANT NOTE:

Creating and developing **Infant Learning** products is accompanied by a responsibility that we at **VTech**® take very seriously. We make every effort to ensure the accuracy of the information, which forms the value of our products. However, errors sometimes can occur. It is important for you to know that we stand behind our products and encourage you to call our Consumer Services Department at 1-800-521-2010 in the U.S. or 1-877-352-8697 in Canada, with any problems and/or suggestions that you might have. A service representative will be happy to help you.

Note:

This equipment has been tested and found to comply with the limits for a Class B digital device, pursuant to Part 15 of the FCC Rules. These limits are designed to provide reasonable protection against harmful interference in a residential installation. This equipment generates, uses and can radiate radio frequency energy and, if not installed and used in accordance with the instructions, may cause harmful interference to radio communications. However, there is no guarantee that interference will not occur in a particular installation. If this equipment does cause harmful interference to radio or television reception, which can be determined by turning the equipment off and on, the user is encouraged to try to correct the interference by one or more of the following measures:

- Reorient or relocate the receiving antenna
- Increase the separation between the equipment and receiver
- Connect the equipment into an outlet on a circuit different from that to which the receiver is connected
- Consult the dealer or an experienced radio/TV technician for help

THIS DEVICE COMPLIES WITH PART 15 OF THE FCC RULES. OPERATION IS SUBJECT TO THE FOLLOWING TWO CONDITIONS:
(1) THIS DEVICE MAY NOT CAUSE HARMFUL INTERFERENCE, AND
(2) THIS DEVICE MUST ACCEPT ANY INTERFERENCE RECEIVED, INCLUDING INTERFERENCE THAT MAY CAUSE UNDESIREED OPERATION.

THIS CLASS B DIGITAL APPARATUS COMPLIES WITH CANADIAN ICES-003.

CET APPAREIL NUMÉRIQUE DE LA CLASSE B EST CONFORME À LA NORME NMB-003 DU CANADA.